

# BUILDING ACOUSTICS & LIGHTING LABORATORIES, INC.

1618 HEADLAND DR.  
FENTON, MO 63026  
(636) - 343-6006  
(636) - 343-6051 FAX

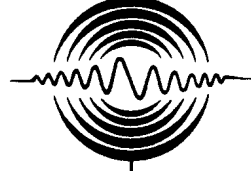

BALLABS CERTIFIED TEST REPORT NO.: 14522.0 DATE 03/17/09  
 PREPARED FOR: SCIENTIFIC LIGHTING PRODUCTS, INC - FENTON, MO  
 DESCRIPTION: 2/32W T8 LAMP 52x7x6" SUSPENDED ENCLOSED/GASKETED LUMINAIRE  
 WHITE REFLECTOR w/CLEAR ACRYLIC DROP LENS  
 SYLVANIA BALLSAT #QTP2x32T8/UNV ISH-SC WATTS=67 REFL=88%  
 CATALOG NBR: CT2-2X32T8-LIRA  
 LAMP TYPE : F32T8/835/RS RATED LUMENS 2950. NBR. LAMPS:- 2

VERT ANG	CANDLEPOWER DISTRIBUTION					ZONAL LUMENS
	HORIZONTAL ANGLE					
	0	22.5	45	67.5	90	
0	1018.	1018.	1018.	1018.	1018.	
5	1022.	1032.	1042.	1047.	1048.	99.2
10	1027.	1046.	1067.	1080.	1084.	
15	1018.	1049.	1073.	1064.	1073.	299.9
20	996.	1037.	1042.	1081.	1091.	
25	933.	983.	1008.	1060.	1082.	469.6
30	859.	900.	959.	1020.	1036.	
35	805.	840.	939.	992.	1030.	579.3
40	725.	777.	881.	966.	998.	
45	648.	716.	838.	926.	947.	634.6
50	576.	665.	803.	893.	907.	
55	491.	594.	751.	825.	874.	639.8
60	391.	500.	637.	764.	844.	
65	302.	433.	594.	796.	852.	595.6
70	211.	351.	599.	726.	762.	
75	129.	261.	509.	564.	595.	448.6
80	66.	238.	356.	474.	523.	
85	33.	140.	305.	412.	450.	299.6
90	19.	105.	233.	324.	357.	
95	7.	61.	188.	287.	326.	191.6
100	0.	29.	133.	225.	263.	
105	0.	13.	80.	166.	200.	94.9
110	0.	13.	35.	101.	132.	
115	0.	11.	14.	48.	73.	27.2
120	0.	8.	0.	22.	31.	
125	0.	8.	0.	17.	20.	7.9
130	0.	0.	0.	0.	17.	
135	0.	0.	0.	0.	0.	.0
140	0.	0.	0.	0.	0.	.0
145	0.	0.	0.	0.	0.	.0
150	0.	0.	0.	0.	0.	.0
155	0.	0.	0.	0.	0.	.0
160	0.	0.	0.	0.	0.	.0
165	0.	0.	0.	0.	0.	.0
170	0.	0.	0.	0.	0.	.0
175	0.	0.	0.	0.	0.	.0
180	0.	0.	0.	0.	0.	.0

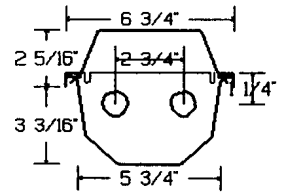
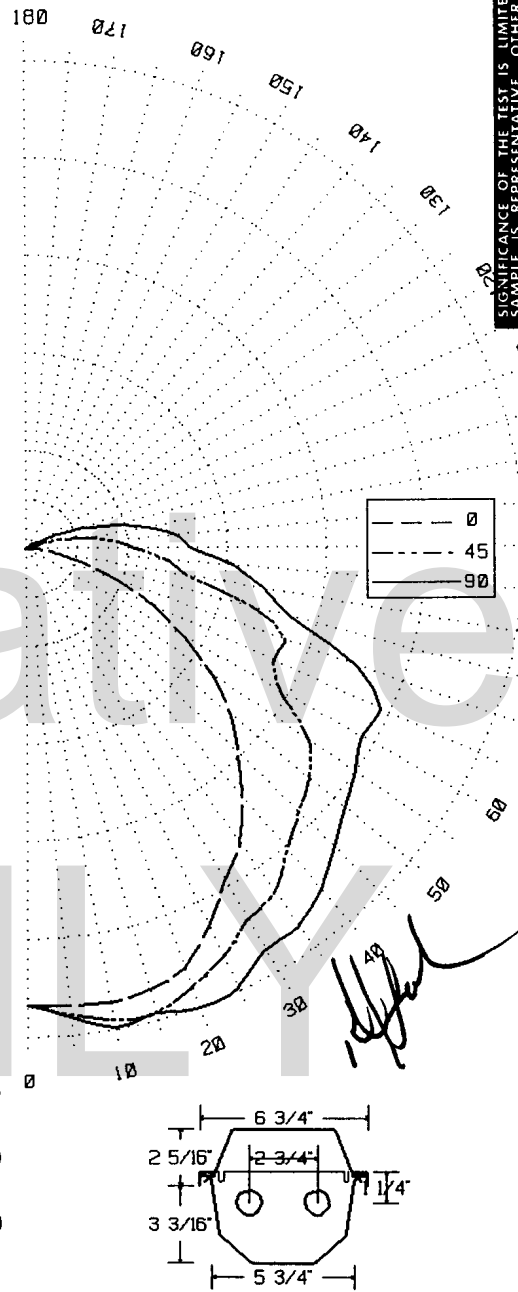

LUMEN SUMMARY							
ZONE	LUMENS	%LAMP	%FIXT	ZONE	LUMENS	%LAMP	%FIXT
0- 30	869.	14.7	19.8	90-120	314.	5.3	7.2
0- 40	1448.	24.5	33.0	90-130	322.	5.5	7.3
0- 60	2722.	46.1	62.0	90-150	322.	5.5	7.3
0- 90	4066.	68.9	92.7	90-180	322.	5.5	7.3
TOTAL LUMINAIRE = 0-180					4388.	74.4	100.0
IES SPACING CRITERIA: END= 1.3					DIAGONAL = 1.4	CROSS= 1.5	

SIGNIFICANCE OF THE TEST IS LIMITED TO THE DEGREE THAT THE TESTED SAMPLE IS REPRESENTATIVE. OTHER FACTORS AFFECT FIELD PERFORMANCE.

BALLABS CERTIFIED TEST REPORT NO.: 14522.0 DATE 03/17/09  
 PREPARED FOR: SCIENTIFIC LIGHTING PRODUCTS, INC - FENTON, MO  
 DESCRIPTION: 2/32W T8 LAMP 52x7x6"SUSPENDED ENCLOSED/GASKETED LUMINAIRE  
 WHITE REFLECTOR w/CLEAR ACRYLIC DROP LENS  
 SYLVANIA BALLSAT #QTP2x32T8/UNV ISH-SC WATTS=67 REFL=88%  
 CATALOG NBR: CT2-2X32T8-LIRA  
 LAMP TYPE : F32T8/835/RS RATED LUMENS 2950. NBR. LAMPS:- 2  
 \*\*\*\*\*

LUMINANCES-CD/SQ-M  
 HORIZONTAL ANGLE

VERT ANGLE	0	45	90
45	4629.	3806.	4301.
55	4324.	3638.	4233.
65	3610.	3186.	4569.
75	2518.	3166.	3700.
85	1913.	2342.	3455.

\*\*MAXIMUM BRIGHTNESSES NOT MEASURED\*\*

\*\*\*\*\*

ZONAL CAVITY COEFFICIENTS OF UTILIZATION

EFFECTIVE FLOOR CAVITY REFLECTANCE=.20

CEILING	.80		.70		.50		.30		.10		.00							
WALL	.70	.50	.30	.10	.70	.50	.30	.10	.50	.30	.10	.50	.30	.10	.00			
RCR																		
0	.87	.87	.87	.87	.85	.85	.85	.85	.80	.80	.80	.75	.75	.75	.71	.71	.71	.69
1	.78	.74	.70	.67	.76	.72	.68	.65	.68	.65	.62	.64	.61	.59	.60	.58	.57	.55
2	.70	.64	.58	.53	.68	.62	.56	.52	.58	.54	.50	.55	.51	.48	.52	.49	.46	.44
3	.64	.56	.49	.44	.62	.54	.48	.43	.51	.46	.42	.48	.44	.40	.46	.42	.39	.37
4	.58	.49	.42	.37	.56	.47	.41	.36	.45	.39	.35	.42	.38	.34	.40	.36	.33	.31
5	.53	.43	.36	.30	.51	.42	.35	.30	.39	.34	.29	.37	.32	.28	.35	.31	.28	.26
6	.49	.38	.31	.26	.47	.37	.30	.26	.35	.29	.25	.33	.28	.24	.32	.27	.24	.22
7	.45	.34	.27	.22	.43	.33	.27	.22	.31	.26	.22	.30	.25	.21	.28	.24	.20	.19
8	.41	.31	.24	.19	.40	.30	.23	.19	.28	.23	.19	.27	.22	.18	.26	.21	.18	.16
9	.38	.27	.21	.17	.36	.27	.21	.16	.25	.20	.16	.24	.19	.16	.23	.18	.15	.14
10	.35	.25	.19	.15	.34	.24	.18	.14	.23	.18	.14	.22	.17	.14	.21	.17	.13	.12

TESTED IN ACCORDANCE WITH CURRENT IES PROCEDURES